

**LONGI**

**Hi-MO X6 Artist Ultra Black**

LR5-54HTDB

**420~435M**

**223** W/m<sup>2</sup>



**Ultimate Solar Design**



**Uncompromised Quality**



**Absolute in Technology**



**Green Power, Green Life**

**25**

**25-year Warranty for Materials and Processing**

**30**

**30-year Warranty for Extra Linear Power Output**

**Complete System and Product Certifications**

IEC 61215, IEC 61730, UL 61730  
ISO9001:2015: ISO Quality Management System  
ISO14001: 2015: ISO Environment Management System  
ISO45001: 2018: Occupational Health and Safety  
IEC62941: Guideline for module design qualification and type approval





**22.3%**

MAX MODULE  
EFFICIENCY

**0~3%**

POWER  
TOLERANCE

**<1.5%**

FIRST YEAR  
POWER DEGRADATION

**0.40%**

YEAR 2-30  
POWER DEGRADATION

## Additional Value

### 30-Year Power Warranty

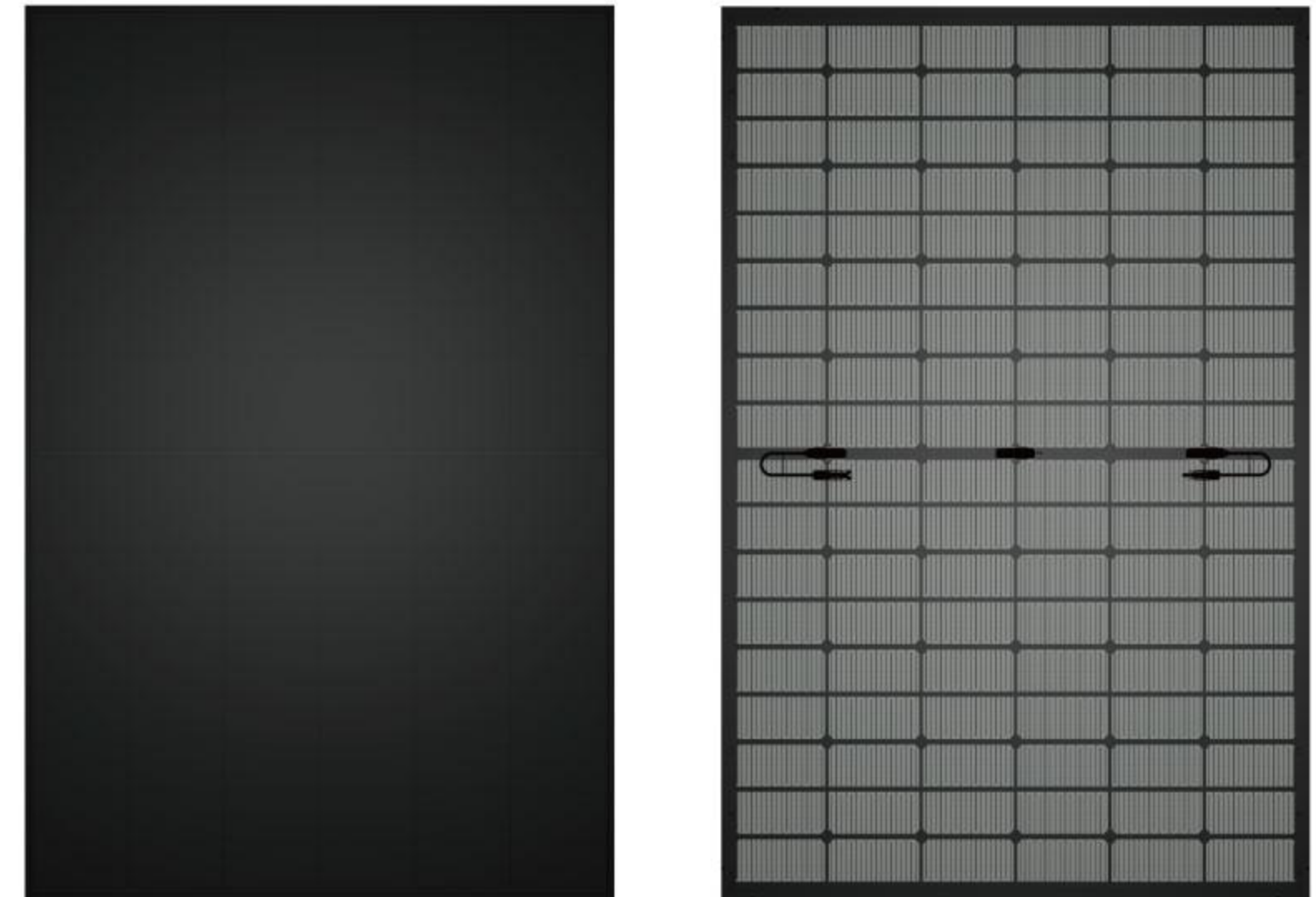
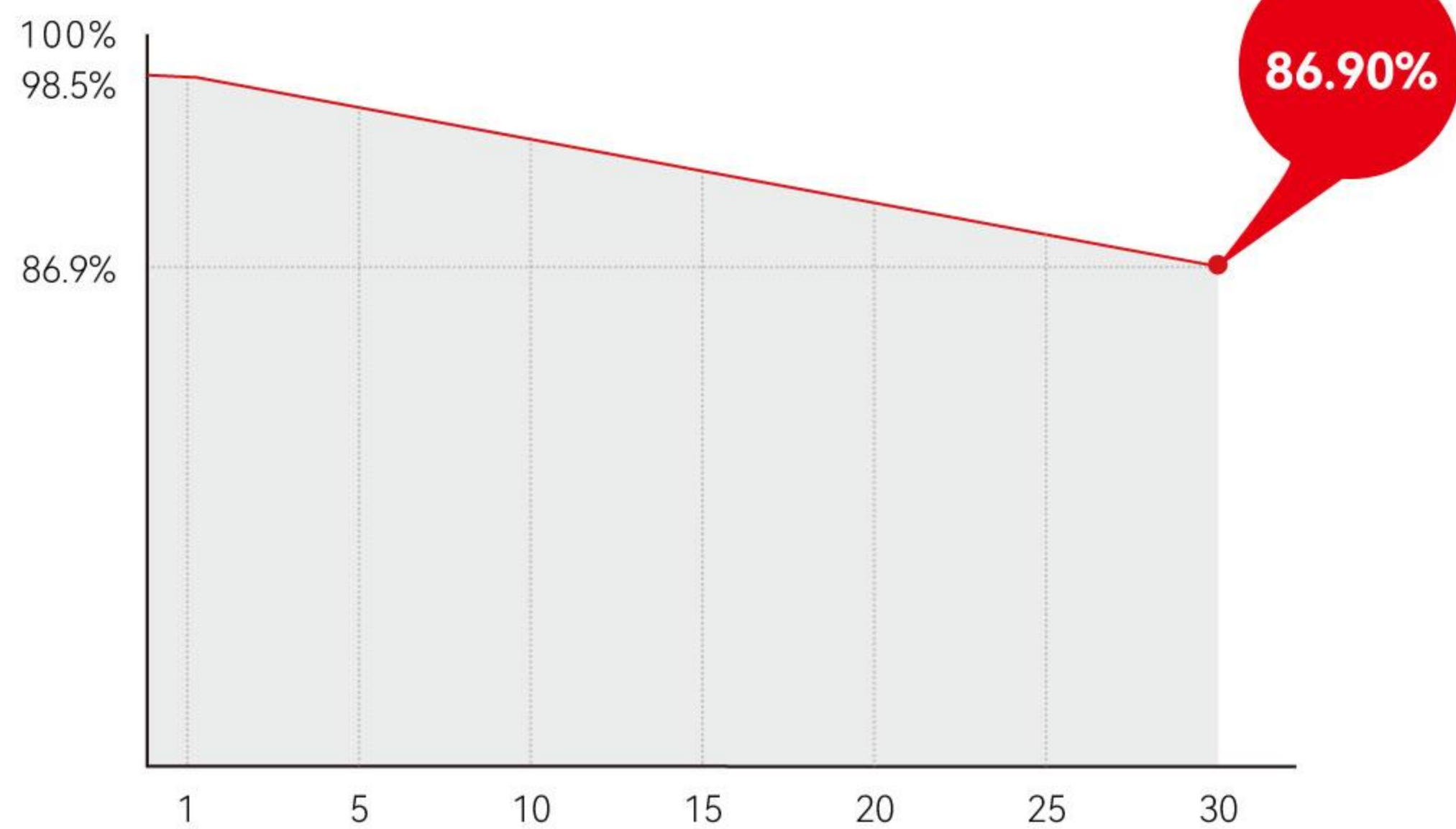

## Mechanical Parameters

Cell Orientation	108 (6×18)
Junction Box	IP68
Output Cable	4mm <sup>2</sup> , ±1200mm length can be customized
Glass	Double glass, 2.0mm structure glass+1.6mm semi-tempered glass
Frame	Anodized aluminum alloy frame
Weight	22.5kg
Dimension	1722×1134×30mm
Packaging	36 pcs per pallet / 216pcs per 20'GP / 936pcs per 40'HC

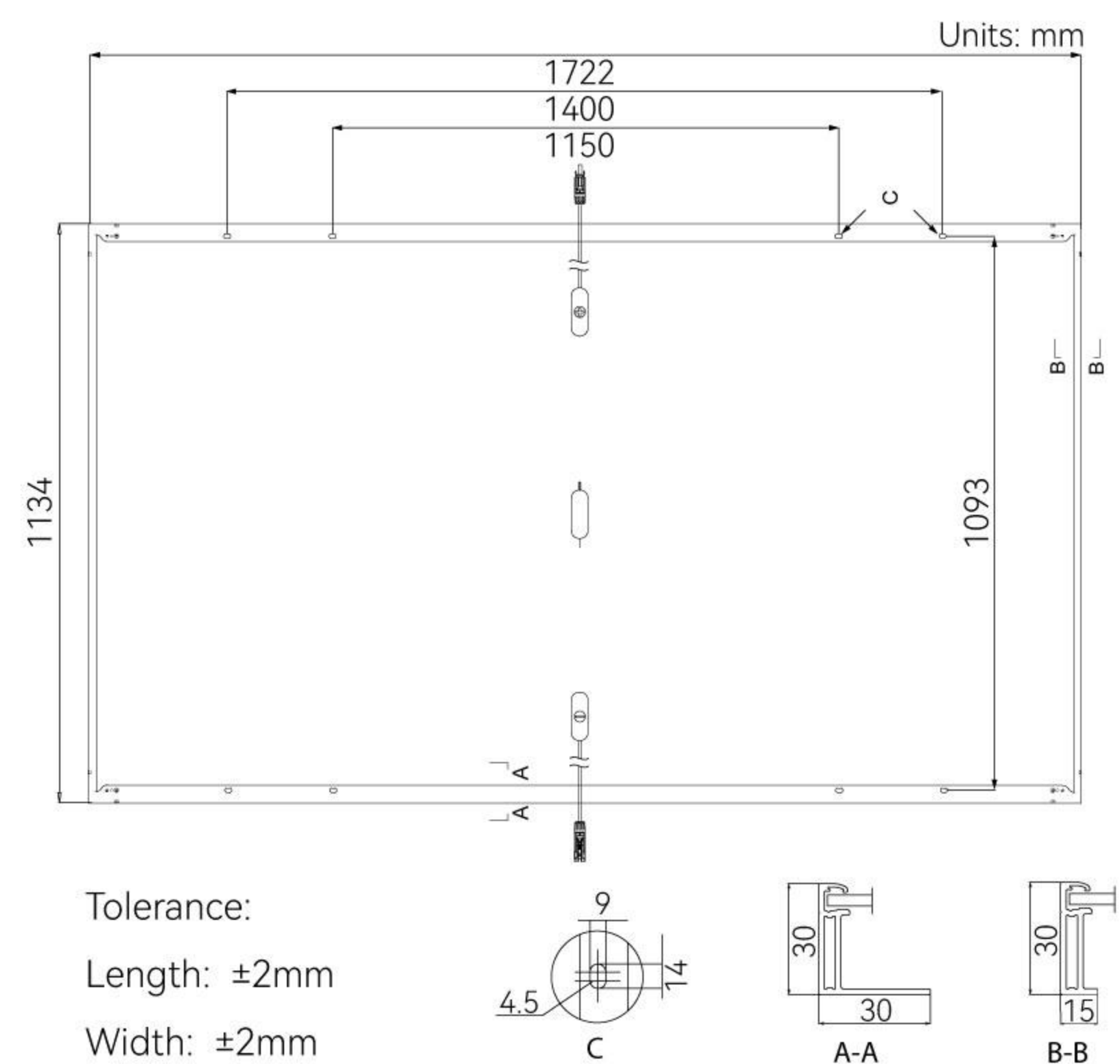

## Electrical Characteristics

STC : AM1.5 | 1000W/m<sup>2</sup> | 25°C

NOCT : AM1.5 | 800W/m<sup>2</sup> | 20°C | 1m/s

Test uncertainty for Pmax: ±3%

Module Type	LR5-54HTDB-420M		LR5-54HTDB-425M		LR5-54HTDB-430M		LR5-54HTDB-435M	
	STC	NOCT	STC	NOCT	STC	NOCT	STC	NOCT
Testing Condition								
Maximum Power (Pmax/W)	420.00	313.80	425.00	317.60	430.00	321.30	435.00	325.00
Open Circuit Voltage (Voc/V)	39.45	37.04	39.65	37.23	39.85	37.42	40.05	37.60
Short Circuit Current (Isc/A)	13.54	10.94	13.61	10.99	13.69	11.06	13.77	11.12
Voltage at Maximum Power (Vmp/V)	33.07	30.18	33.27	30.36	33.47	30.54	33.67	30.72
Current at Maximum Power (Imp/A)	12.71	10.40	12.78	10.46	12.85	10.53	12.92	10.58
Module Efficiency(%)	21.5		21.8		22.0		22.3	

## Operating Parameters

Operational Temperature	-40°C ~ +85°C
Power Output Tolerance	0 ~ 3%
Maximum System Voltage	DC1500V (IEC)
Maximum Series Fuse Rating	30A
Nominal Operating Cell Temperature	45±2°C
Protection Class	Class II
Fire Rating	IEC Class C

## Mechanical Loading

Front Side Maximum Static Loading	6000Pa
Rear Side Maximum Static Loading	3600Pa
Hailstone Test	25mm Hailstone at the speed of 23m/s

## Temperature Ratings (STC)

Temperature Coefficient of Isc	+0.050%/°C
Temperature Coefficient of Voc	-0.230%/°C
Temperature Coefficient of Pmax	-0.290%/°C